

# Temperature Sensor NTC M8-HS



- ▶ Wide measurement range: -55 to 300°C
- ▶ Very short response time
- ▶ Strong protection against ambient temperature
- ▶ Robust design

This sensor is designed to measure temperatures up to 300°C of oil, water, fuel or air. This signal is used as a control value for engine control units or as a measurement value which is logged in a data acquisition system.

The NTC-sensing element has a negative temperature coefficient. This means, that with increasing temperature the conductivity rises and the resistance decreases. To improve a good protection against the ambient temperature, the housing is made of stainless steel and partly filled with an isolation-paste. The main benefit of the sensor is a very robust design and its very short response time.

## Application

Application	-55 to 300°C
Storage temperature range	0 to 100°C
Bio fuel compatibility	-

## Technical Specifications

### Mechanical Data

Male thread	M8x1
Wrench size	12 mm
Installation torque	8 Nm
Weight w/o wire	8 g
Sealing	O-Ring 6.35 x 1.78 mm

### Electrical Data

Characteristic	NTC
Nominal resistance at 25°C	10 kOhm ± 1 %

## Characteristic

Accuracy at 25°C (homogeneous cond.)	± 0.3°C
Accuracy at 100°C (homogeneous cond.)	± 1.3°C
Response time tau 63 in still water	< 4 s

## Characteristic Application

T [°C]	R [Ohm]
-55	519,910
-35	158,090
-20	71,668
-10	44,087
0	27,936
10	18,187
20	12,136
25	10,000
30	8,284
40	5,774
50	4,103
60	2,967
70	2,182
80	1,629
90	1,234
100	946.6
110	735.5
120	578.1
130	459.4
140	368.8

150	298.9
160	244.4
170	201.6
180	167.6
190	140.4
200	118.5
210	100.7
220	86.08
230	74.05
240	64.08
250	55.75
260	48.76
270	42.87
280	37.86
290	33.59
300	29.94

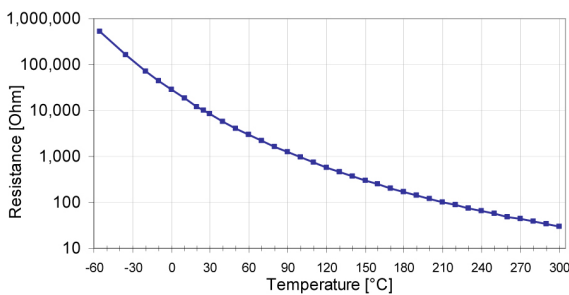

**Connectors and Wires**

Connector	ASL 6-06-05PN-HE
Mating connector	F 02U 000 231-01

**Dimensions**

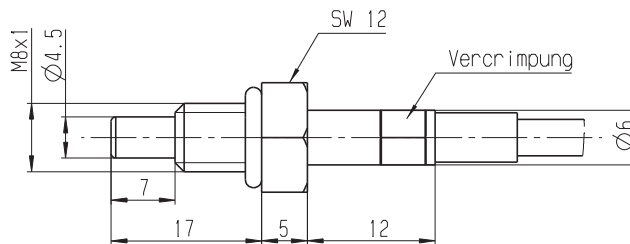

ASL 0-06-05SN-HE	
Pin 1	-
Pin 2	Sig-
Pin 3	Sig+
Pin 4	-
Pin 5	-
Various motorsport and automotive connectors are available on request.	
Wire size	AWG 24
Wire length L	15 to 50 cm
Please specify the required wire length with your order.	

**Installation Notes**

The NTC M8-HS can be connected directly to most control units using a pull-up resistor (typically 1 or 3 kOhm).  
 Any mounting orientation is possible.  
 Please find further application hints in the offer drawing and free download of the sensor configuration file (\*.sdf) for the Bosch Data Logging System at our homepage.

**Safety Note**  
 The sensor is not intended to be used for safety related applications without appropriate measures for signal validation in the application system.

**Ordering Information**

**Temperature Sensor NTC M8-HS**  
 Order number **F 02U V00 509-01**

**Represented by:**

**Europe:**  
 Bosch Engineering GmbH  
 Motorsport  
 Robert-Bosch-Allee 1  
 74232 Abstatt  
 Germany  
 Tel.: +49 7062 911 9101  
 Fax: +49 7062 911 79104  
 motorsport@bosch.com  
 www.bosch-motorsport.de

**North America:**  
 Bosch Engineering North America  
 Motorsport  
 38000 Hills Tech Drive  
 Farmington Hills, MI 48331-3417  
 United States of America  
 Tel.: +1 248 876 2977  
 Fax: +1 248 876 7373  
 motorsport@bosch.com  
 www.bosch-motorsport.com

**Latin America:**  
 Robert Bosch Ltda  
 Motorsport  
 Av Juscelino Kubitscheck de Oliveira  
 11800  
 Zip code 81460-900 Curitiba - Parana  
 Brasilia  
 Tel.: +55 41 3341 2057  
 Fax: +55 41 3341 2779

**Asia-Pacific:**  
 Bosch Engineering Japan K.K.  
 Motorsport  
 18F Queen's Tower C, 2-3-5 Minato  
 Mirai Nishi-ku, Yokohama-shi  
 Kanagawa 220-6218  
 Japan  
 Tel.: +81 45 650 5610  
 Fax: +81 45 650 5611  
 www.bosch-motorsport.jp

**Australia, New Zealand and South Africa:**  
 Robert Bosch Pty. Ltd  
 Motorsport  
 1555 Centre Road  
 Clayton, Victoria, 3168  
 Australia  
 Tel.: +61 (3) 9541 3901  
 motor.sport@au.bosch.com