

Twin Single Fire Coil 2x1

www.bosch-motorsport.com



BOSCH
Invented for life



- ▶ Max. 35 kV
- ▶ $2 \times \leq 50 \text{ mJ}$
- ▶ Max. $2.1 \text{ kV}/\mu\text{s}$
- ▶ Developed for twin spark engines
- ▶ 2 independent coils in 1 housing

This ignition coil is specifically developed for engines with twin sparks.

The advantage of this coil is that there are two separated coils in one housing. So the ignition can be parallel or serial-offset with some angular degrees.

The Twin Single Fire Coil 2x1 has no integrated transistor and requires an ECU with internal ignition power stages.

This coil is a series coil, produced in great quantities. The advantages of coils from run production are low costs and high robustness.

Application

Spark energy	$2 \times \leq 50 \text{ mJ}$
Primary current	$2 \times \leq 7.5 \text{ A}$
Operating temperature range outer core	-20 to 140°C
Storage temperature range	-40 to 110°C
Max. vibration	$\leq 400 \text{ m/s}^2$ at 5 to 2,500 Hz

Technical Specifications

Mechanical Data

Weight	496 g
Mounting	Screw fastening

Electrical Data

Primary resistance with wire	420 mΩ
Secondary resistance	Incapable of measurement
High voltage rise time	$\leq 2.1 \text{ kV}/\mu\text{s}$
Max. high voltage at $1 \text{ M}\Omega \parallel 10 \text{ pF}$	$\leq 35 \text{ kV}$
Spark current	$\leq 95 \text{ mA}$
Spark duration at $1 \text{ kV} \parallel 1 \text{ M}\Omega$	$\leq 1.14 \text{ ms}$
Suppression diode / EFU	

Characteristic

Measured with power stage	IGBT IRG4BC40S ($U_{ce} = 600 \text{ V}$)
---------------------------	---

Connectors and Wires

Connector	Bosch Compact
Mating connector	D 261 205 335-01

Pin 1	Coil 2 (b) ECU Ignition Power Stage
Pin 2	U _{batt}
Pin 3	Coil 1 (a) ECU Ignition Power Stage

Various motorsport and automotive connectors are available on request.

Please specify the required wire length with your order.

Characteristic dwell times [ms]

U _{batt}	I _{primary}					
	4.0A	5.0A	6.0A	7.0A	7.5A	8.0A
6V	4.6	6.5	9.2	13.6		
8V	2.9	3.9	4.8	5.7	6.1	6.5
10V	2.1	2.74	3.36	3.9	4.0	4.2
12V	1.65	2.11	2.55	2.92	3.04	3.18
14V	1.36	1.74	2.07	2.35	2.45	2.55
16V	1.16	1.47	1.75	1.98	2.05	2.14
18V	1.02	1.28	1.51	1.7	1.77	1.84

Measured values are without loom resistance. Loom resistance must be less than the primary resistance. The needed dwell time is to be verified through current measurement

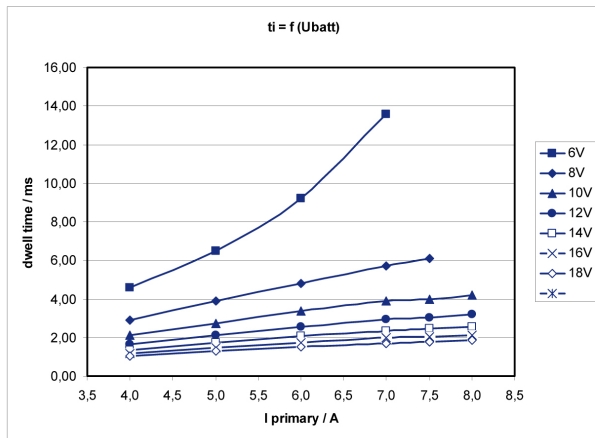
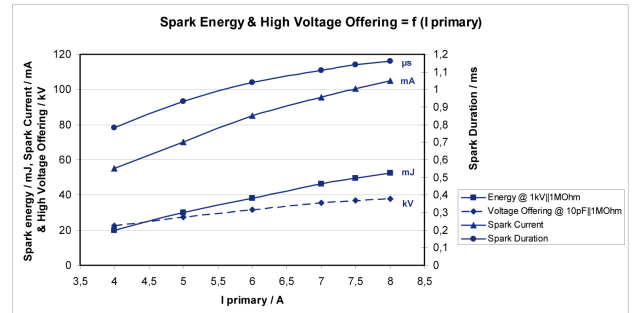

Dwell time

Spark energy and provided high voltage

I _{prim.}	Spark energy	-duration	-current	Hi voltage
4 A	20 mJ	0.784 ms	55 mA	22.5 kV
5 A	29.9 mJ	0.931 ms	70 mA	27.5 kV
6 A	38 mJ	1.04 ms	85 mA	31.5 kV
7 A	46.2 mJ	1.11 ms	90 mA	35.4 kV
7.5 A	49.5 mJ	1.14 ms	95 mA	36.7 kV
8 A	52.4 mJ	1.16 ms	105 mA	37.7 kV

Spark energy

Installation Notes

The coil can be mounted directly on the engine.

Ignition wires are needed to connect the coil with the spark plug.

The Twin Single Fire Coil 2x1 has no integrated transistors and requires an ECU with internal ignition power stages, e.g. IGBT or BIP.

For technical reasons the values of the coils may vary.

Please regard the specified limit values.

Please find further application hints in the offer drawing at our homepage.

In case of ignition-caused malfunctions, please use screened sensor wires.

Ordering Information

Twin Single Fire Coil 2x1

Order number **0 221 503 035**

Dimensions

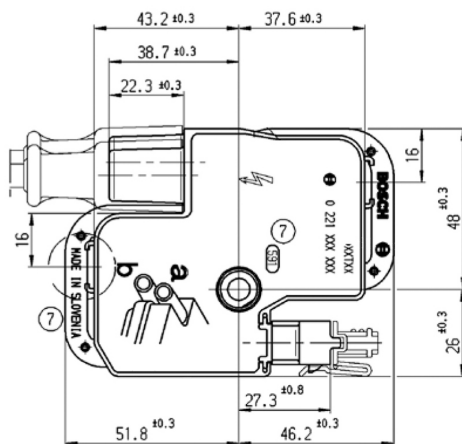
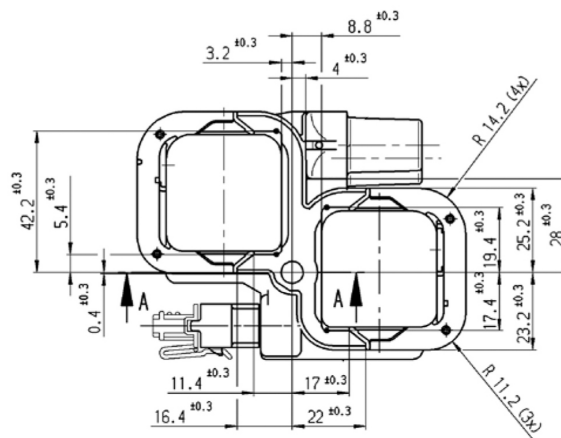

Schaltbild
CIRCUIT DIAGRAM

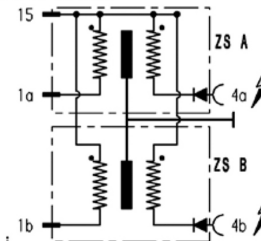

Achtung :
Primärschluß führt gefährliche Spannung !
CAUTION :
PRIMARY CONNECTION HAS DANGEROUS VOLTAGE !

Represented by:

Europe:

Bosch Engineering GmbH
Motorsport
Robert-Bosch-Allee 1
74232 Abstatt
Germany
Tel.: +49 7062 911 79101
Fax: +49 7062 911 79104
motorsport@bosch.com
www.bosch-motorsport.de

North and South America:

Bosch Engineering North America
Motorsports
38000 Hills Tech Drive
Farmington Hills, MI 48331-3417
United States of America
Tel.: +1 248 876 2977
Fax: +1 248 876 7373
motorsport@bosch.com
www.bosch-motorsport.com

Asia-Pacific:

Bosch Engineering Japan K.K.
Motor Sport Department
3-33-8 Tsuruya-cho, Kanagawa-ku, Yokohama-shi
Kanagawa 221-0835
Japan
Tel.: +81 45 410 1650
Fax: +81 45 410 1651
motorsport@bosch.com
www.bosch-motorsport.com