

ABS M4 Kit

www.bosch-motorsport.com



- Suitable for front-wheel, rear-wheel and four-wheel drive vehicles

The ABS M4 Kit is developed for the operation in front-, rear- or 4-wheel drive vehicles. A vehicle specific wiring harness is included in the Kit.

The ABS M4 is specifically adapted for motorsport use. Individual car parameters like e.g. vehicle weight, vehicle track, wheel weights, wheel circumferences, wheel base or number of increments can be calibrated with software free of charge. Please contact your Bosch Motorsport dealer for further information.

Technical Specifications

Variations

ABS M4 Kit 1	ABS M4 Kit 2
Customer specific wiring harness with motorsport connectors, wheel speed sensors with production-type connectors	Customer specific wiring harness with motorsport connectors, wheel speed sensors with motorsport connectors

Mechanical Data

Hydraulic unit with attached ECU

Serial housing, dust- and damp-proof

Vibration damped circuit board

38 pin connector

2 hydraulic valves per wheel	
2 brake circuits (front and rear)	
2 hydraulic high pressures pumps	
2 hydraulic accumulators 3 cm ³ /each	
Standard fittings	2 x master cylinders M12 x 1 4 x brake cylinders M10 x 1
Size	125 x 80.3 x 129.6 mm
Weight	about 1,850 g
Operating temperature	-30 to 130°C
Max. shock	50 g less than 6 ms

Electrical Data

Supply voltage	8 to 16 V, max. 26 V for 5 min
Max. peak voltage	35 V for 200 ms
Power consumption	8 W stand-by, 230 W in operation

Inputs

4 active wheel speed DF11

Brake pressure (front brake circuit)

Longitudinal acceleration, lateral acceleration, yaw rate

9 adjustment settings applicable for OEMs (Pos. 1-9)

2 adjustment settings applicable for Temas (Pos. 10 and 11)

ABS function can be deactivated (Pos. 12)

Brake light switch

Outputs

ABS warning light (MIL)

Communication

CAN interface

Content of Kit and Weights

Hydraulic unit with attached ECU About 1,850 g

Pressure sensor About 40 g

Yaw/acceleration sensor About 60 g

12 position function switch About 50 g

4 wheel speed sensors DF11 standard About 50 g/each

ABS warning light (MIL) About 50 g

Vehicle specific wiring harness with motorsport connectors Depends on version

Clubsport wiring harness About 1,500 g

Mounting and vibration-damping boards About 80 g

Mounting board for hydraulic unit About 210 g

Optional Accessories

Data logger C 50 F 02U V01 164-01

Data logger C 60 F 02U V00 875-03

Display DDU 7 F 02U V01 130-04

Communication interface MSA Box II F 02U V00 327-02

Wheel speed signal splitter Quad with 2 motorsport connectors F 02U V00 203-03

Quad with 1 motorsport connector F 02U V00 335-03

Porsche 991 with 1 motorsport connector F 02U V01 928-01

Field of application

ABS for front-wheel, rear-wheel or four-wheel drive racing cars

Part numbers

ABS M4-Package 1 (incl. wiring harness with motorsport connectors, individual layout depending on customer requirements, wheel speed sensors with production-type connectors) F 02UV00 289-01

ABS M4-Package 2 (incl. wiring harness with motorsport connectors, individual layout depending on customer requirements, wheel speed sensors with motorsport connectors) F02U V00 290-01

ABS M4-Package Clubsport (incl. wiring harness with motorsport connectors, wheel speed sensors with serial connectors) 1MBaud:
F 02U V01 289-49 (DF11S)
F 02U V00 543-13 (for DF11i)
500 kBaud:
F 02U V01 289-48 (DF11S)
F 02U V00 543-12 (for DF11i)

Ordering Information

ABS M4 Kit 1

Order number **F 02U V00 289-01**

ABS M4 Kit 2

Order number **F 02U V00 290-01**

Dimensions

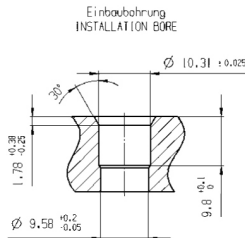
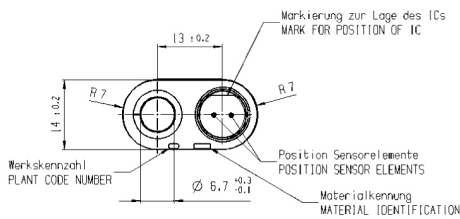
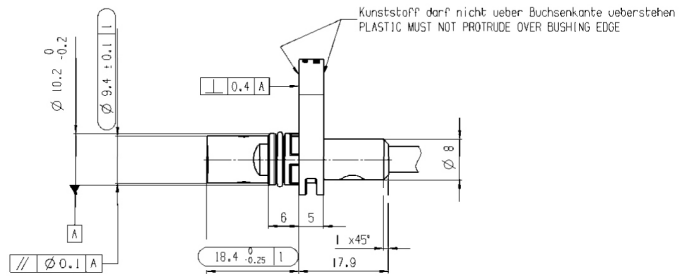
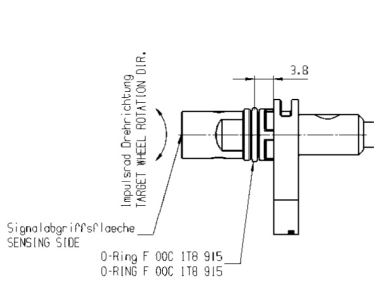
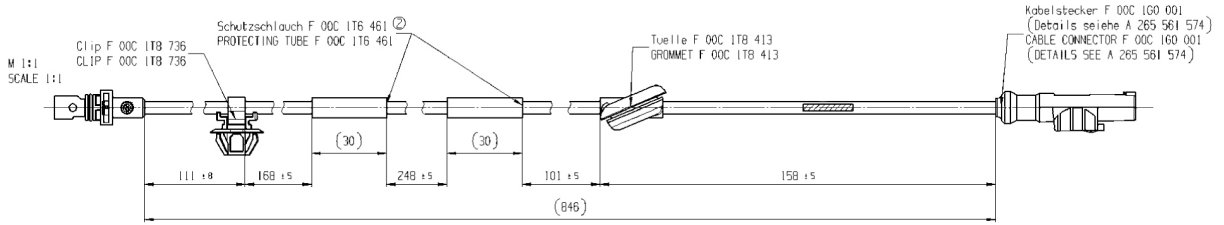

Material/MATERIAL

Gehäuse: Polyamid waerme-
stabilisiert
HOUSING: POLYAMIDE HEAT
STABILIZED

Leitung: Mantelleitung zweiadrig
Aussen ∅ : 5,0 ± 0,3
Mantelisolierung: Polyurethan-
Elastomer 95: 5 Shore A.
CABLE: MOLDED CABLE COVER
TWO CORES, D_c : 5,0 ± 0,3
COVER INSULATION: POLY-
URETHANE ELASTOMER 95: 5
SHORE A.

Buchse: Stahl
BUSHING: STEEL

Wheel Speed Sensor

Represented by:

Europe:
Bosch Engineering GmbH
Motorsport
Robert-Bosch-Allee 1
74232 Abstatt
Germany
Tel.: +49 7062 911 9101
Fax: +49 7062 911 79104
motorsport@bosch.com
www.bosch-motorsport.de

North America:
Bosch Engineering North America
Motorsport
38000 Hills Tech Drive
Farmington Hills, MI 48331-3417
United States of America
Tel.: +1 248 876 2977
Fax: +1 248 876 7373
motorsport@bosch.com
www.bosch-motorsport.com

Latin America:
Robert Bosch Ltda
Motorsport
Av Juscelino Kubitschek de
Oliveira 11800
Zip code 81460-900
Curitiba - Parana
Brasil
Tel.: +55 41 3341 2057
Fax: +55 41 3341 2779

Asia-Pacific:
Bosch Engineering Japan K.K.
Motorsport
18F Queen's Tower C, 2-3-5 Minato Mirai
Nishi-ku, Yokohama-shi
Kanagawa 220-6218
Japan
Tel.: +81 45 650 5610
Fax: +81 45 650 5611
www.bosch-motorsport.jp

Australia, New Zealand and South Africa:
Robert Bosch Pty. Ltd
Motorsport
1555 Centre Road
Clayton, Victoria, 3168
Australia
Tel.: +61 (3) 9541 3901
motor.sport@au.bosch.com